

# PHF TB3030X70MM

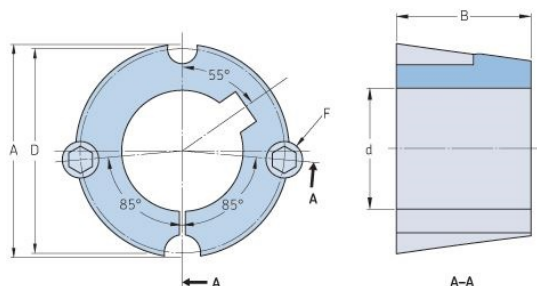

|                        |                 |
|------------------------|-----------------|
| Bushing no.            | TB3030          |
| d = Bore diameter (mm) | 70              |
| Bore diameter (in)     | 2.76            |
| Keyway width (mm)      | 20              |
| Keyway width (in)      | 0.79            |
| Keyway depth (mm)      | 4.9             |
| Keyway depth (in)      | 0.19            |
| A (mm)                 | 108             |
| A (in)                 | 4.25            |
| B (mm)                 | 76.2            |
| B (in)                 | 3               |
| D (mm)                 | 101.6           |
| D (in)                 | 4               |
| E (mm)                 | -               |
| E (in)                 | -               |
| F (mm)                 | 15.875 x 31.750 |
| F (in)                 | -               |
| Weight (kg)            | 2.23            |
| Weight (lbs)           | 4.92            |